

SITE PLAN OF PROPOSED THREE STORIED RESIDENTIAL BUILDING U/S 393A OF K.M.C. ACT, 1980 UNDR BLDG. RULE-2009, AT PREMISES NO.-109, NIRANJAN PALLY, B-BLOCK, WARD No.-113, BOROUGH-XI, P.S.-BANSDRONI, PREVIOUS-REGENT PARK, KOLKATA-700070.

AREA OF LAND:-

1. AS PER TITLE DEED = 280.565 Sq.m. (4 Kh. - 03 Ch.- 05 Sq.ft.)
2. AS PER BOUNDARY DEC. = 271.452 Sq.m. (4 Kh. - 0 Ch.- 41.909 Sq.ft.)

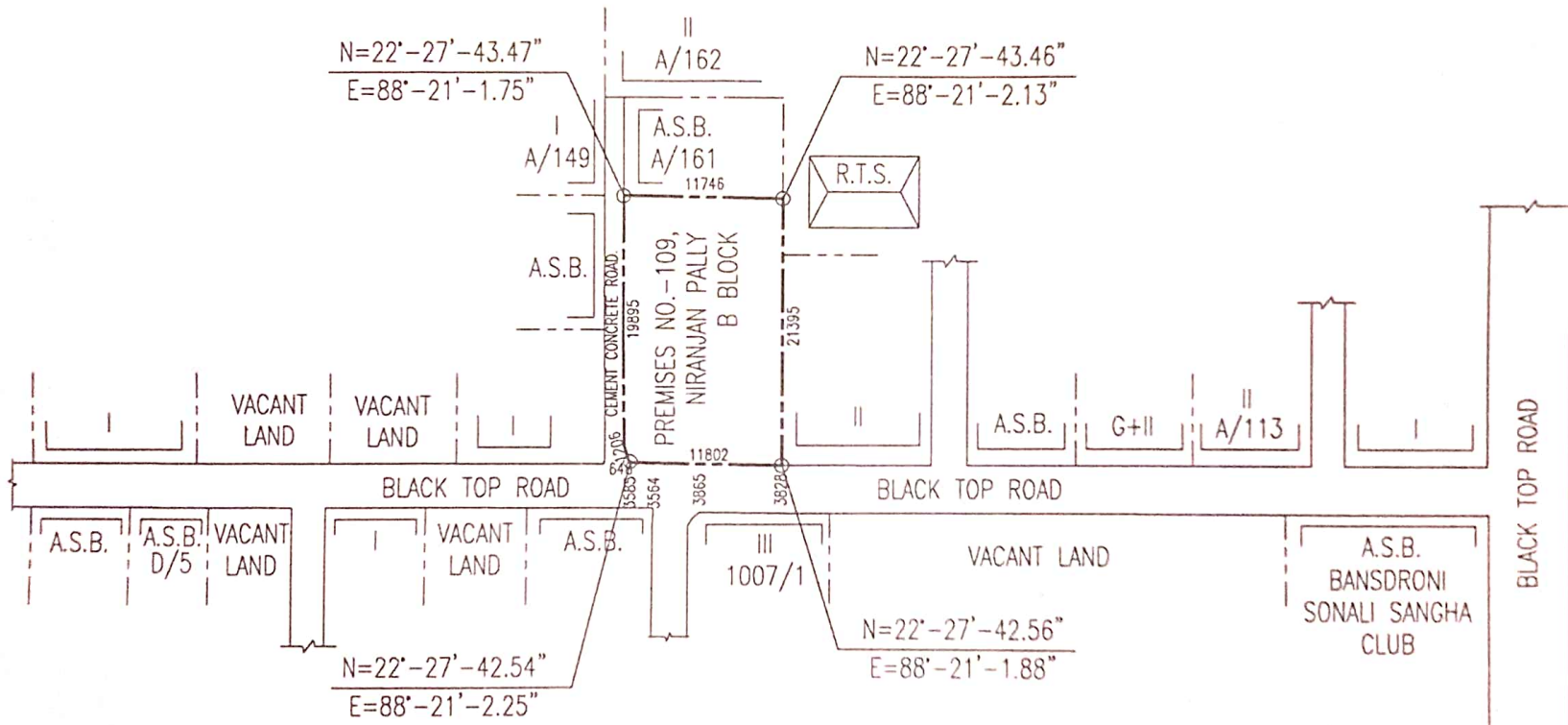

SITE PLAN  
SCALE - 1 : 600

SHILA SAHA  
*Shila Saha*  
PROPRIETOR

SIGNATURE OF OWNER

*Avijit Gupta*  
AVIJIT GUPTA  
Kolkata Municipal Corporation  
LBS/II/1624

SIGNATURE OF L.B.S.

**KEY PLAN OF PROPOSED THREE STORIED RESIDENTIAL BUILDING U/S 393A OF K.M.C. ACT, 1980 UNDR BLDG. RULE-2009,  
AT PREMISES NO.-109, NIRANJAN PALLY, B-BLOCK, WARD No.-113, BOROUGH-XI, P.S.-BANSDRONI, PREVIOUS-REGENT  
PARK, KOLKATA-700070.**

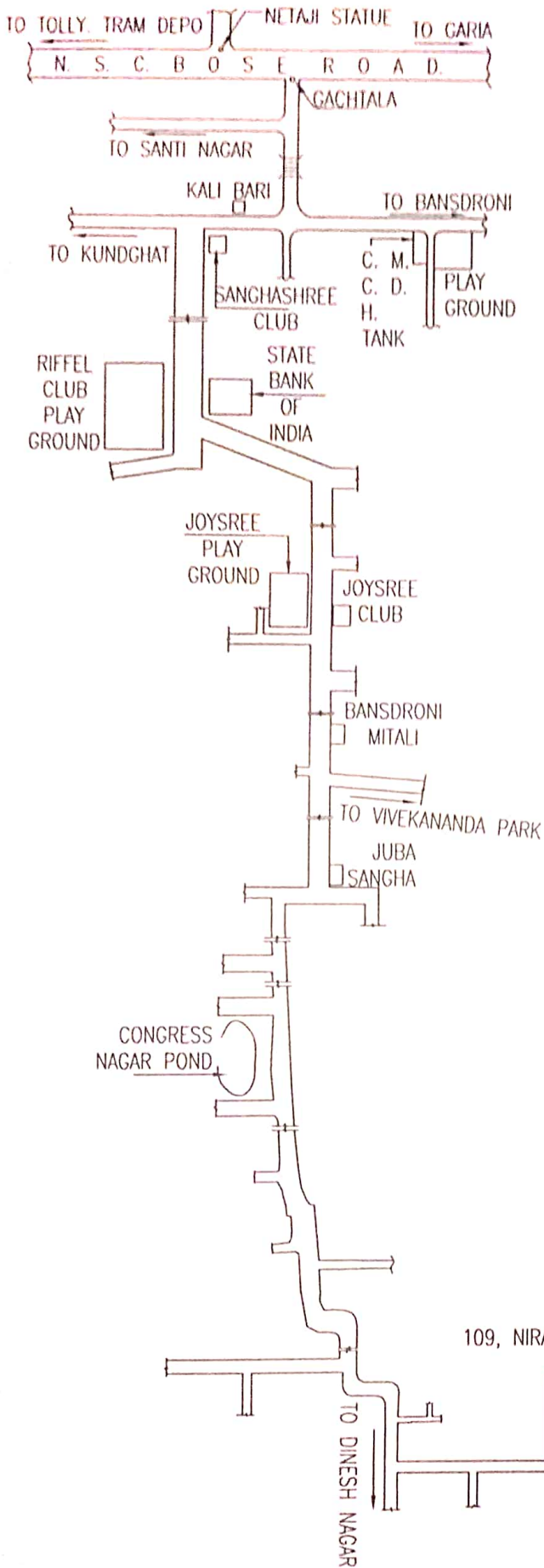

AREA OF LAND:-

1. AS PER TITLE DEED = 280.565 Sq.m.  
(4 Kh. - 03 Ch. - 05 Sq.ft.)

2. AS PER BOUNDARY DEC. = 271.452 Sq.m.  
(4 Kh. - 0 Ch. - 41.909 Sq.ft.)

*Signature of Avijit Gupta*

**AVIJIT GUPTA**  
Kolkata Municipal Corporation  
LBS/II/1624

SIGNATURE OF L.B.S.

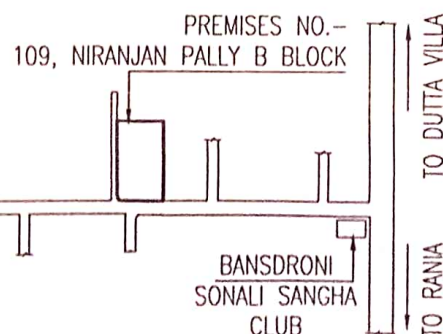

**KEY PLAN**  
SCALE = 1 : 4000

SHILA SAHA  
*Shila Saha*

PROPRIETOR

SIGNATURE OF OWNER